



Non-marring grab model TBP

Capacity 500 - 1500 kg

The TBP non-marring grab is suitable for lifting, turning and transporting of plates with a sensitive surface without leaving behind indentations.

It can be used for aluminium and stainless steel plate or those with an extremely hard surface.

! The surface of the plate must be free of oil, grease or any other liquid to ensure safe transport.

Technical data model TBP

Model	EAN-No. 4025092*	Capacity kg	Jaw capacity Z mm	Weight kg
TBP 0,5	*556378	500	0 - 10	3.0
TBP 1,5	*556392	1500	0 - 20	12.6

Dimensions model TBP

Model	TBP 0,5	TBP 1,5
A, mm	127	215
B, mm	200	345
D, mm	52	75
E, mm	69	135
F, mm	87	131
G, mm	76	118
H, mm	13	20
I, mm	20	24
Ø C, mm	55	85

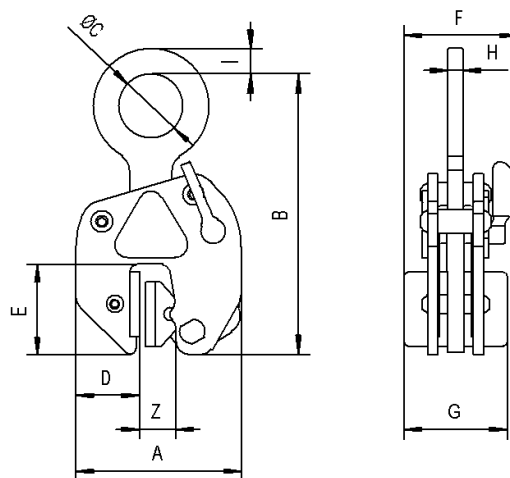

! The min. load is 10% of the nominal WLL!